

NOTE:  
 ALL DISTANCES ARE SUGGESTED  
 MINIMUMS ACTUAL SITE CONDITIONS  
 MAY REQUIRE ADJUSTMENT OF FINAL  
 SIGN PLACEMENTS TO AVOID  
 CONFLICT WITH OTHER SIGNS OR  
 DRIVEWAYS  
 SIGN LOCATIONS SHOWN ARE  
 APPROXIMATE ONLY

█ SPEED ZONE LOCATION

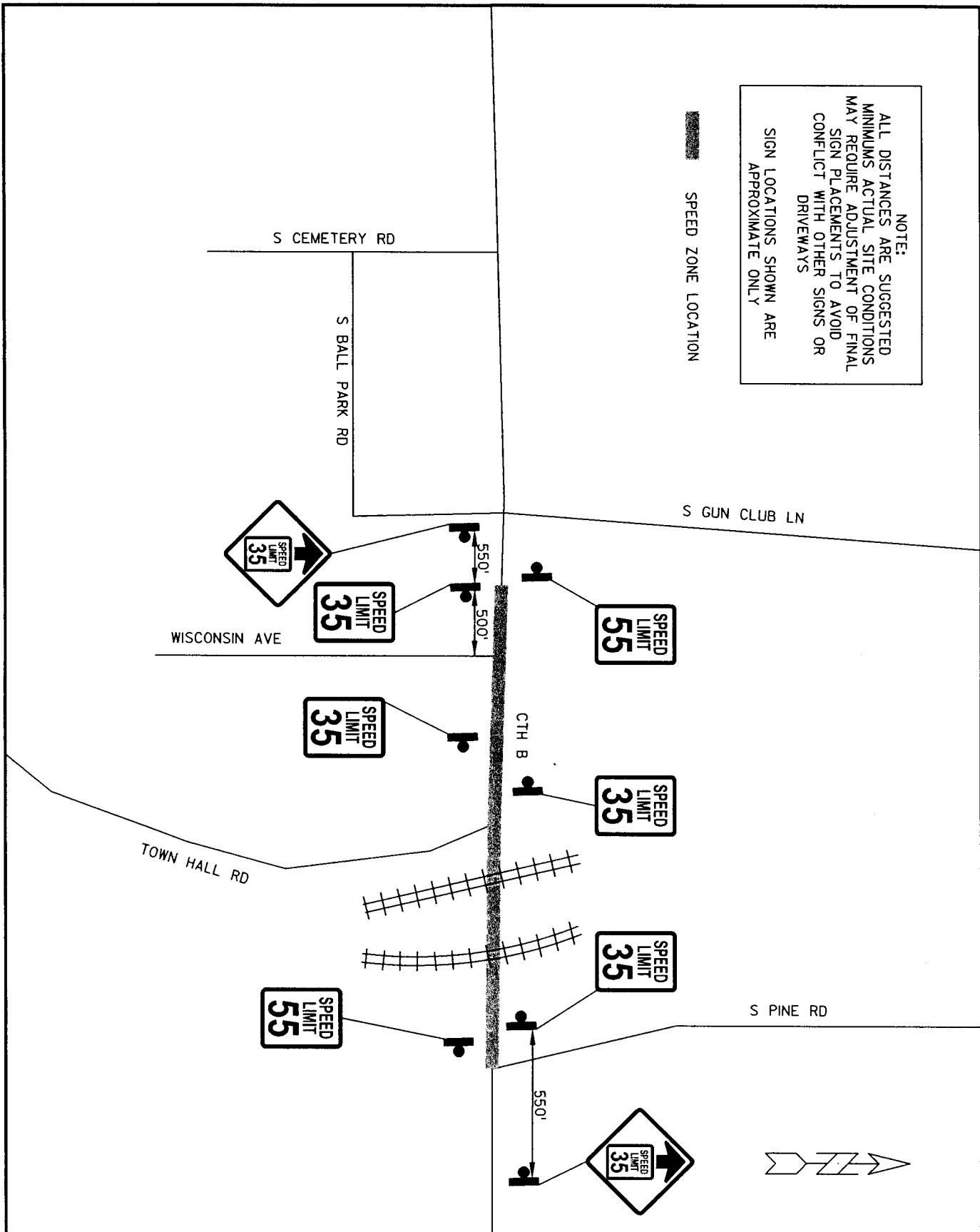

**JEWELL**  
 associates engineers, inc.  
 Engineers - Planners - Surveyors

EXHIBIT 5  
 RECOMMENDED SPEED ZONE LAYOUT  
 CTH B  
 0.1 MILES WEST OF CEMETERY ROAD TO PINE  
 ROAD

COUNTYWIDE SPEED  
 MANAGEMENT STUDY  
 DOUGLAS COUNTY, WISCONSIN  
 SEPTEMBER 23, 2011